

Premium Booth 3mW x 3mD Right Corner Booth

FA-A-9_R-Cnr
3mW x 3mD x 3.5mH

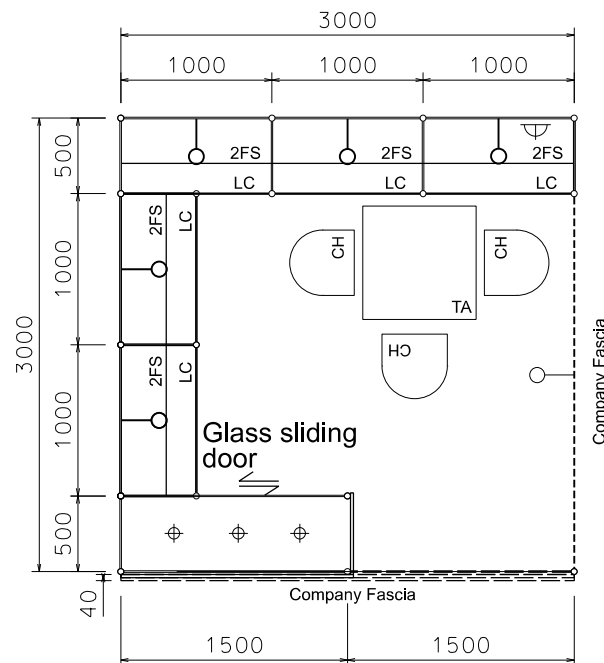

PLAN

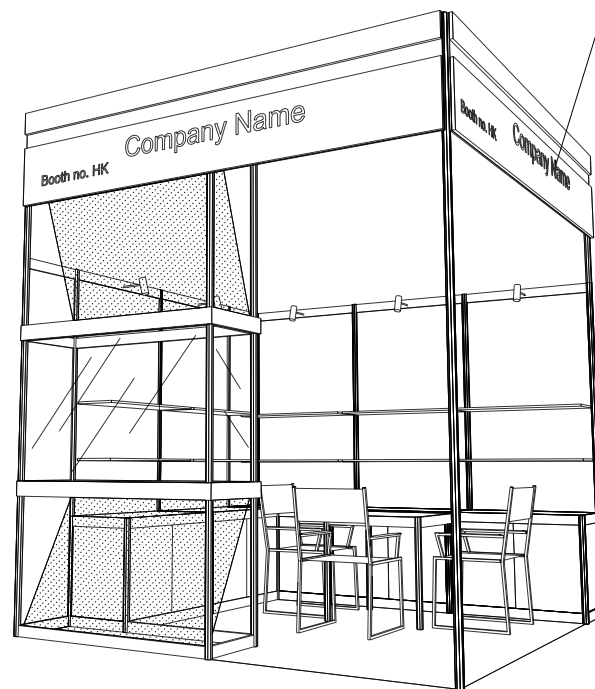

PERSPECTIVE N.T.S.

Fascia background :
Respect - M3173
Company name in
black colour sticker

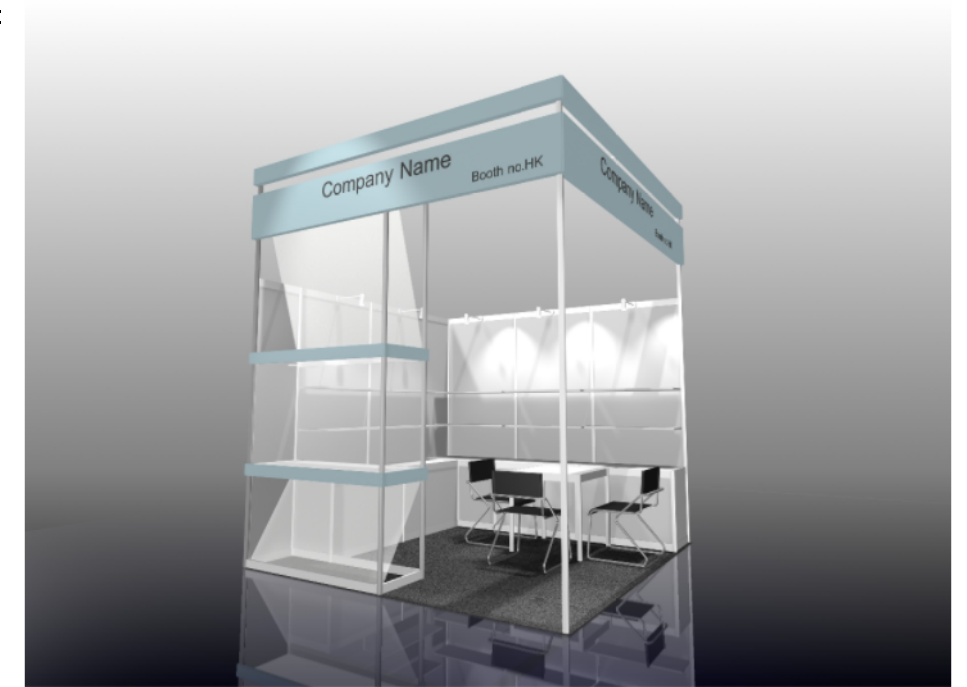

COLOUR PERSPECTIVE N.T.S.

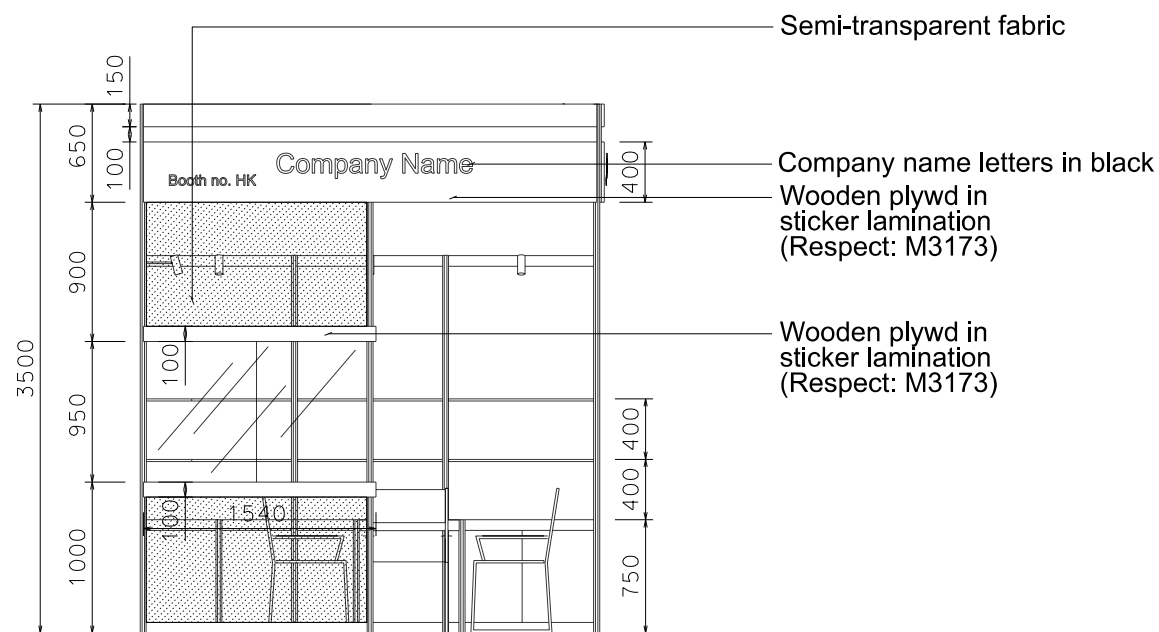

FRONT ELEVATION

BOOTH SPECIFICATION		QTY
	Front glass showcase 1.5mW x 0.5mD x 0.95mH w/ 3 x 7W LED downlights	1
	Lockable cabinet (1mL x 0.5mD x 0.75mH)	5
	Wooden flat shelf (1mW x 0.3mD)	10
	Square meeting table (0.7m X 0.7m x 0.75mH)	1
	Black leather chair	3
	Longarmed spotlight w/13 watt LED lamp (yellow)	6
	500w Square pin power socket	1

FILE PATH - \\10.10.8.25\Structure_Permanent_Data\Local_Fair_Premium_Booth_2011\FA-A-9-R-Cnr-2d\layout_update.dgn



NOTES UNLESS OTHERWISE SPECIFIED ALL DIMENSIONS ARE IN MM.

.....
.....
.....

REVISION

20-03-2009
31-03-2009
02-04-2009
03-07-2009
28-12-2009
21-05-2013
04-06-2013
20-05-2015
27-03-2019

DATE: 27-03-2019

SCALE: 1 : 50 (A3)

DRAWN BY: ..

CHECKED BY:

TITLE

Premium
Booth
FA-A-9
Right Side Corner

PROJECT

PREMIUM BOOTH
3m x 3m

DATE: XXXXXXXX

SHEET

FA-A01a