

Premium Booth 3mW x 3mD Right Corner Booth

FA-B-9_R-Cnr
3mW x 3mD x 3.5mH

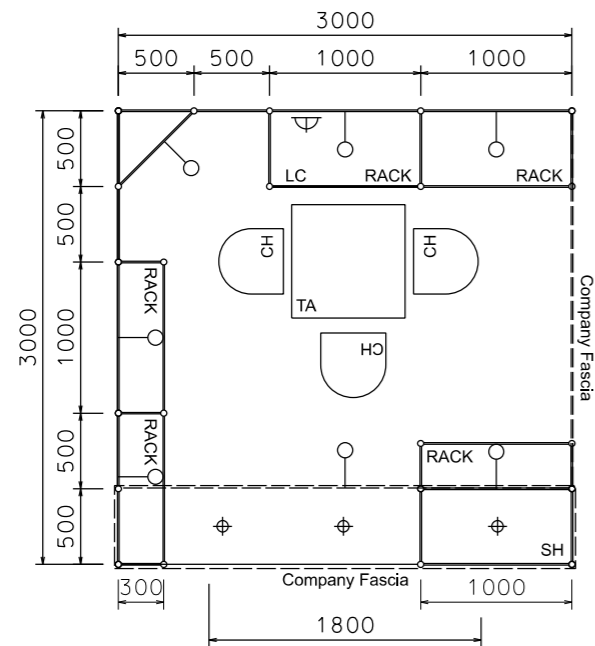

PLAN

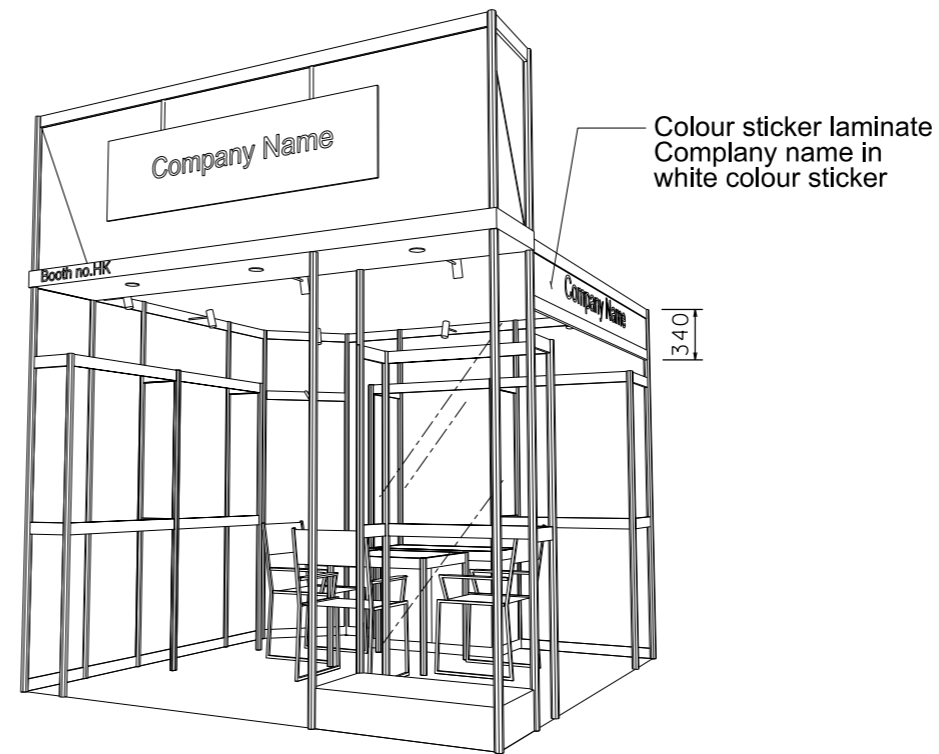

PERSPECTIVE N.T.S

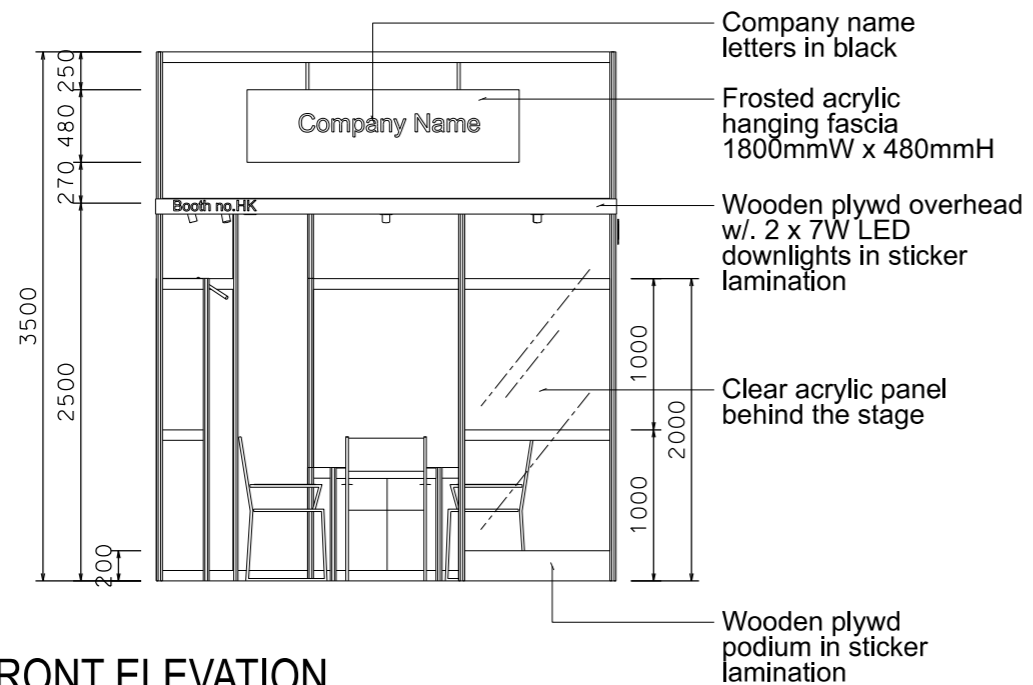

FRONT ELEVATION

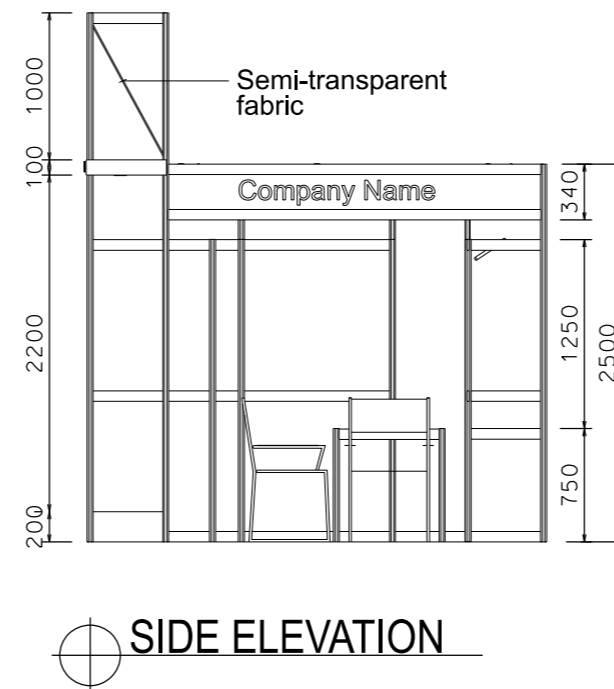

SIDE ELEVATION

BOOTH SPECIFICATION		QTY
	Front display podium with clear acrylic back panel (1mW x 0.2mH) spray paint fin - pantone #241C w/. 1 x 7W LED downlight	1
	1 layer hanging rack (1mL x 0.5mD x 2mH) w/. lockable cabinet underneath (1mL x 0.5mD x 0.75mH)	1
	2 layers hanging rack (1mW x 0.5mD x 1mH/2mH)	1
	2 layers hanging rack (1mW x 0.3mD x 1mH/2mH)	3
	Vertical garment hook	1
	Square meeting table (0.7m X 0.7m x 0.75mH)	1
	Black leather chair	3
	Longarmed spotlight w/13 watt LED lamp (yellow)	7
	7W LED light (for fascia)	2
	500w Square pin power socket	1

FILE PATH - \\10.10.8.25\Structure_Permanent_Data\Local_Fair_Premium_Booth_2011\FA-B-Layout\FA-B-2dLayout_update.dgn



NOTES UNLESS OTHERWISE SPECIFIED ALL DIMENSIONS ARE IN MM.

CONFIRMED - Date : 01/04/2009

REVISION

02-01-2009
20-03-2009
31-03-2009
02-04-2009
03-07-2009
23-09-2009
30-12-2009
22-03-2019

DATE: 22-03-2019

SCALE: 1 : 50 (A3)

DRAWN BY: ..

CHECKED BY:

TITLE

Premium Booth
FA-B-9
R- Corner

PROJECT

PREMIUM BOOTH
3m x 3m
R Corner

DATE: XXXXXXXX

SHEET

FA-B01b